



A UTC Fire & Security Company

ADVANCE RFID Contactless Electronic Lock

ADVANCE RFID (Radio Frequency Identification) combines the extensive benefits of the Onity design-centric ADVANCE lock with industry-standard contact-less RFID technology.

- **RFID Reader:** Contactless Proximity Type Reader compatible with MiFare® (ISO14443A and ISO14443B part 4) and Near Field Communication (NFC) standards.
- **Opening devices:** Multi-segment ISO compliant keycard, wristbands, lanyards, and Near Field Communication (NFC) compatible cellular devices. Compatible with ISO MiFare® Ultra Light, 1K, 4K memory sizes and application segment configurations.
- **Security:** Devices are encrypted with the NXP Crypto-1 encoding algorithm and memory segment is secured using site code or similar security key.
- **Detect/Read Range:** 0 to 2 cm. Tag read cycle does not exceed 1 second including unlocking.

Electronic Features

- **Lock Audit Trail:** Non-volatile memory records the last 500 lock openings including date, time and card used. Removal of batteries does not cause any loss of events.
- **“Do-Not-Disturb” Function:** Deadbolt operated by a thumbturn inside the room for added guest privacy and security.
- Programmable for length of time door remains open, and automatic closing.
- Each new guest card overrides any previous ones preventing re-entry.
- Low battery indicator lights alert hotel staff without disturbing guests.
- Programmable “office-mode” function (free passage).
- Full Masterkeying capabilities.
- Low consumption clock/calendar to control card shifts.

Upgradeability

Upgrading to ADVANCE RFID from the magstripe/dual version is as simple as replacing the reader.

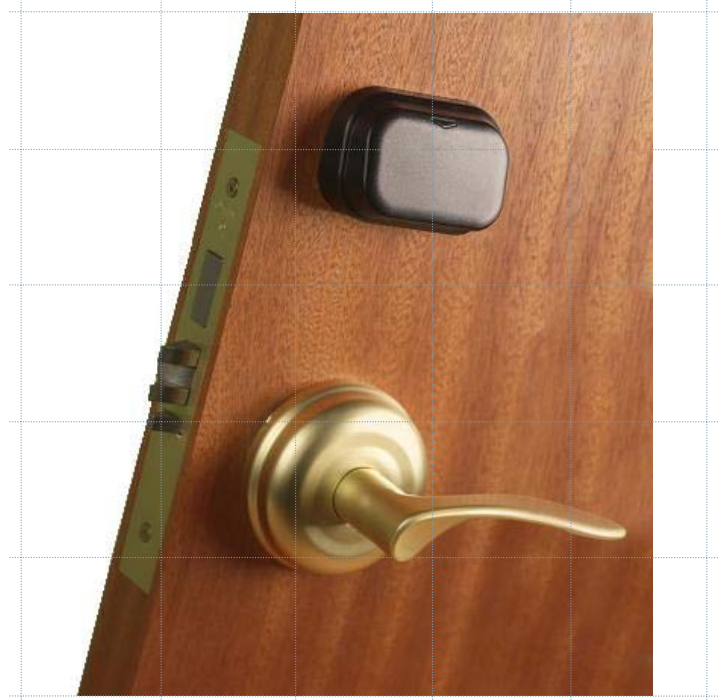
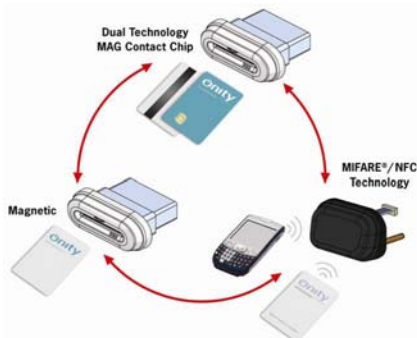

Physical Features

- Off-line installation (no wires required).
- Fits all types of doors.
- **Finishes:** All Onity standard (Satin Chrome, Satin Brass) and special finishes (Polished Brass, Antique Brass, Polished Chrome, Satin Nickel, Dark Bronze and Gold).
- **Levers:** Wing, Toledo and Granada.
- **Latch Mechanisms:** EURO with Auto Latch, ANSI, ANSI with Auto Deadbolt, Cylindrical BLA and DIN.
- Concealed screw design.
- **Batteries:** 4 x standard AA.
- Attractive **cover plates** are available for retrofit projects.

Certifications and Standards

- European Fire Certification EN 1634-1
- FCC & CE certified
- UL10C certified for 3 hours
- BHMA 156.25 & BHMA 156.13