

# ADVANCE

Electronic Lock System **RFID** by Onity



# Advance your locking technology to a new dimension.

One small step in technology is a giant leap for security. Introducing **ADVANCE RFID** by Onity™, a revolutionary locking solution that can help you achieve new heights of convenience and operational efficiency for your facility. This newest generation of **ADVANCE** combines the proven reliability of the world's most trusted name in electronic locking with a fresh new aesthetic designed to meet the needs of the most demanding environments. **ADVANCE RFID** features a unique two-piece modular design that allows you to seamlessly blend your door locks into any décor. So make the leap to **ADVANCE RFID**—it's light years ahead of the rest.

## ADVANCE™ RFID Technology

**ADVANCE RFID** is Onity's newest locking system innovation, providing added convenience as well as enhanced security for facilities of all types. Based on the success of Onity's modular **ADVANCE** locking solution, **ADVANCE RFID** (Radio Frequency Identification) combines the extensive benefits of the design-centric **ADVANCE** lock with industry-standard contact-less **RFID** technology.

Since no physical contact between the card and the reader is required, **ADVANCE RFID** eliminates the need for users to swipe keycards, making authorized access quicker and more convenient.

In addition to traditional keycards, **ADVANCE RFID** is compatible with other form factors, including wristbands, lanyards, and even Near Field Communication (NFC) compatible cellular devices running in MiFare® emulation mode.

**ADVANCE RFID** utilizes the MiFare® Classic technology, which has become a standard worldwide. The system may be used with 1k, 4k and Ultralight tokens, and is **ISO14443A** and **ISO14443B** (part 4) compliant. Onity writes to sector 1 of 1K and 4K MiFare® cards, so the same card can be used for multiple facility technology applications. **ADVANCE RFID** is also compatible with MiFare® Ultralight cards.

## Security

Engineered for optimum security, **ADVANCE RFID** can be used with confidence by property management, security personnel and users alike. The system employs multiple levels of encryption in order to maximize both security and peace of mind.

All Onity **ADVANCE RFID** cards are encrypted with the NXP Crypto-1 encoding algorithm, used in more than 1 billion smartcards throughout the world.

For even more advanced security, Onity has taken the additional step of further encrypting the information which is encoded on the MiFare® token and which is passed between the token and the **ADVANCE RFID** lock. This encryption is unique to Onity, and provides an extra level of protection by ensuring that newly-encoded cards will cancel out existing cards, rendering them invalid.



# Benefits of **ADVANCE RFID**

- Standards-Based
- Supports multi-use capabilities
- Leverages **ADVANCE** lock hardware
- Easy upgrade  
(Less than 5 minutes per door)

## Upgrading to **ADVANCE RFID**

### **Specification for Upgrading from Magnetic Stripe to **ADVANCE RFID****

For current **ADVANCE** magstripe lock customers, upgrading to **ADVANCE RFID** is quick and easy. The two-piece, modular design means that installation is as simple as replacing the existing magnetic stripe reader with the **ADVANCE RFID** reader. The entire installation takes less than 5 minutes per door.

Onity also offers a selection of attractive cover plates for retrofit projects and those upgrading from traditional locks. These cover plates are designed to coordinate with any décor, while eliminating the need for additional cut-outs in the door.

### **Technology Features:**

- Standards-Based MiFare® Technology
  - 14443A, 14443B (part 4)
- Multiple Form Factors Available for Tokens
- Easy Upgradeability (Upgrade Kit Available)
  - Less than 5 Minutes per Door
  - Migration from **ADVANCE** Mag requires only reader replacement and central office upgrade

### **Security Features:**

- NXP Crypto-1 Encoding of Cards
  - Onity Proprietary Encoding of Data
  - Proprietary “Look Ahead” Technology
  - New Card Cancels Existing Card

### **Certifications and Standards:**

- FCC & CE certified
- UL10C certified for 3 hours
- BHMA 156.25 & BHMA 156.13
- European Fire Certification (EN1634-1)

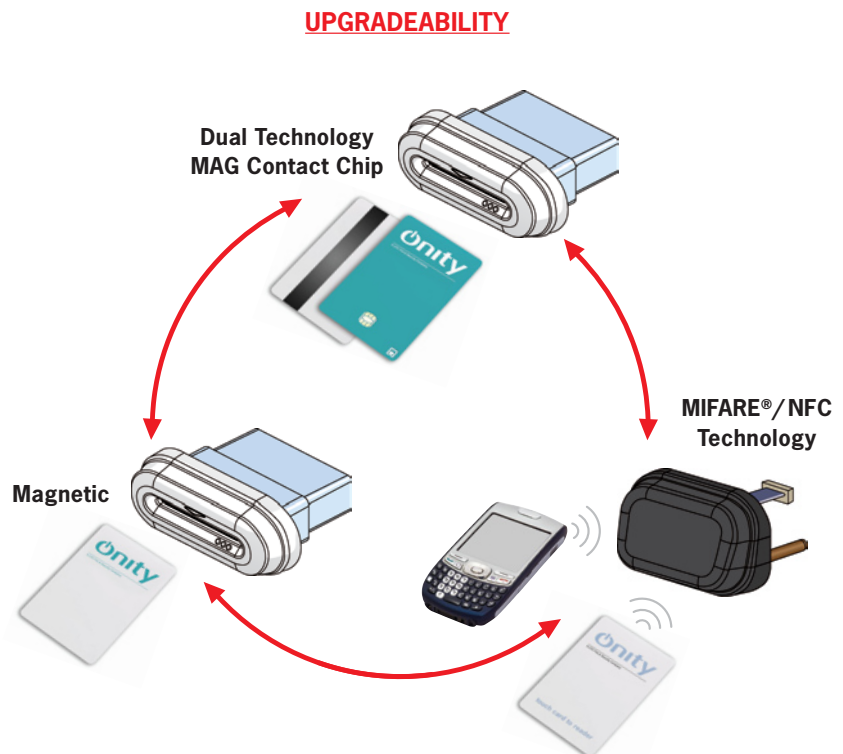

### Dress Plates:

Onity offers a selection of attractive dress plates that are ideal for retrofit projects. Customized designs can also be developed upon request.



### Latch Mechanisms:

Onity offers a wide range of latch mechanisms to suit the needs of any facility.

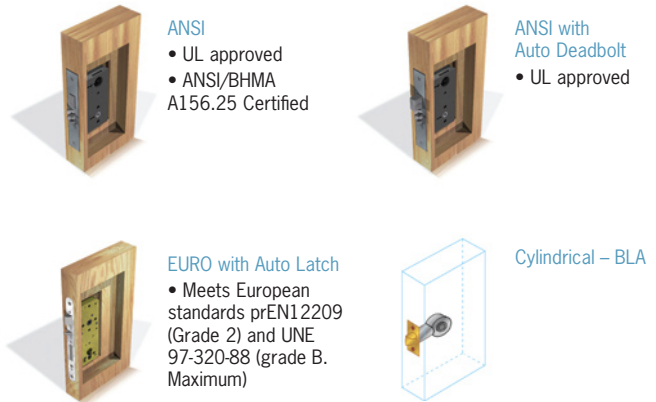

### Finishes:

Complement the elegance of your **ADVANCE RFID** lock with any of these wear-resistant finishes.\*



Satin Chrome (626)



Satin Brass (606)



Antique Brass (609)



Polished Brass (605)

### Handles:

Choose the perfect handle to reflect the architectural design or décor of your property.\*

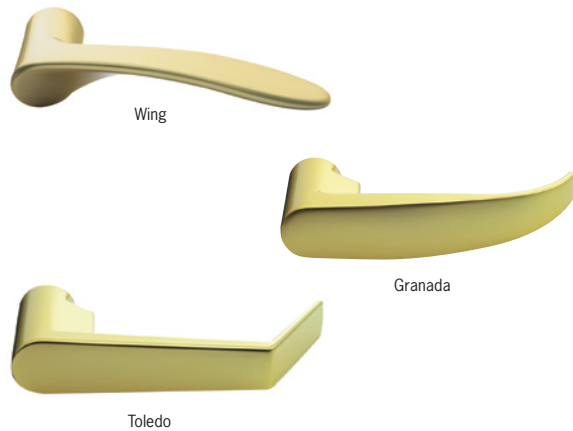

\*More options are available. Please consult your Onity representative for details.